

**CONTENTS PAGE**

1. Description .....1  
 2. Technical characteristics .....1  
 3. Commissioning .....2  
 4. Navigation .....2  
     4.1 Main menu .....3  
     4.2 Manage settings files .....4  
     4.3 Scan product settings .....5  
 5. Care .....6  
 6. Standards .....6

**1. DESCRIPTION**

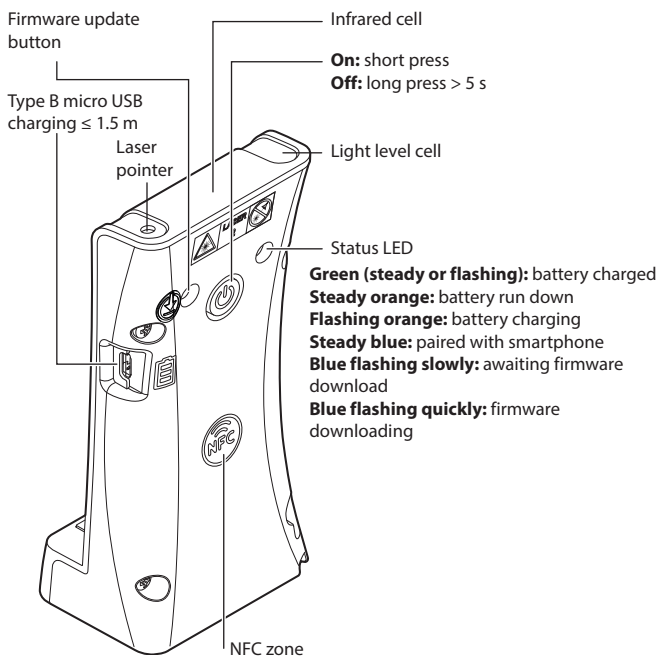

This configuration tool with the Close Up app aids installation and maintenance of compatible Legrand products such as for example motion sensors, Sarlam bulkhead lights or connected self-testing self-contained emergency lighting units.

With this configuration tool you can configure products before, during and after installation, whether switched on (IR) or off (NFC).

The available functions are:

- Product parameter setting in IR and NFC
- Quick access to product technical documents
- Saving and sharing configuration settings
- Copy and paste configuration from one product to another
- Troubleshooting
- Adapting sensor light level meters to their environments
- Easy parameter setting of Legrand DALI sensors
- Comparison of product settings with the original file
- Display of self-contained emergency lighting unit data (fault, last time on standby power)
- Addressing self-contained emergency lighting units (for an addressable installation)
- Assignment of self-contained emergency lighting unit no. (escape sign lighting)

It works with the **Legrand Close Up** app available on Android platforms (Play Store) and iOS (Apple Store)

**2. TECHNICAL CHARACTERISTICS**

Infrared communication technology (13 m max)  
 Storage temperature: -20°C to +70°C  
 Laser pointer: Class 2 laser, 662 nm ± 5 nm, P < 1 mW

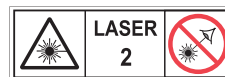

**LASER RADIATION**  
**DO NOT LOOK INTO THE BEAM**  
**CLASS 2 LASER DEVICE**

Weight: 124 g  
 Usage temperature: -5°C to +45°C

**Software version:**

Paired using version ≥ 4.2



**Recharging:** Use a mini USB cable (not supplied) for recharging the configuration tool with a standard USB socket.



**3. COMMISSIONING**

**On first use:**

- Download the **Legrand Close Up** app from the "Store"



- Activate the tool

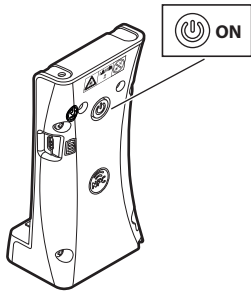

- Launch the **Legrand Close Up** app: the smartphone automatically pairs with the tool\*

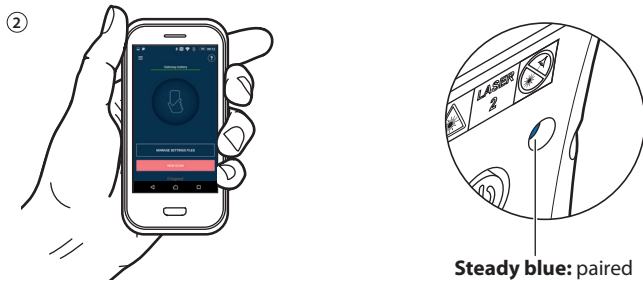
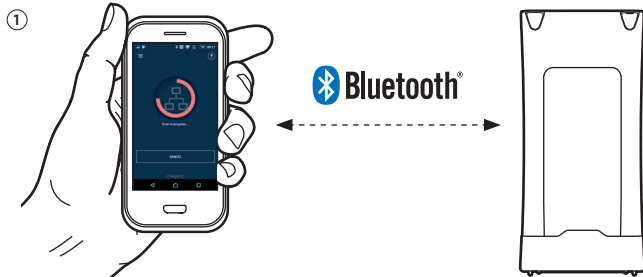

\* If the smartphone does not pair automatically, the app menu suggests manual pairing

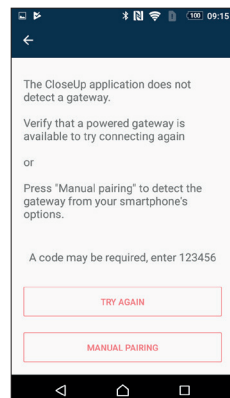
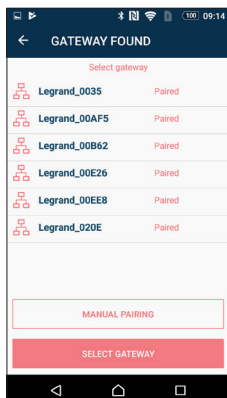

**3. COMMISSIONING (continued)**

- Select the tool number indicated on the product on the smartphone



- Close the **Legrand Close Up** app and reopen it to launch automatic pairing.

**4. NAVIGATION**

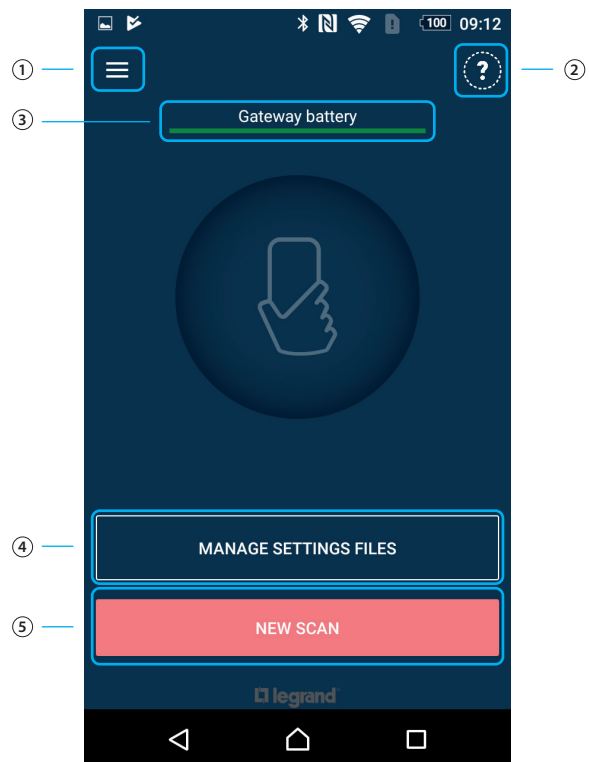

- 1 - Main menu
- 2 - Indicates the software version information
- 3 - Indicates the configuration tool (gateway) battery charge level
- 4 - Used to manage saved or preset settings files
- 5 - Used to scan a product and set its parameters

4. NAVIGATION (continued)

4.1 Main menu

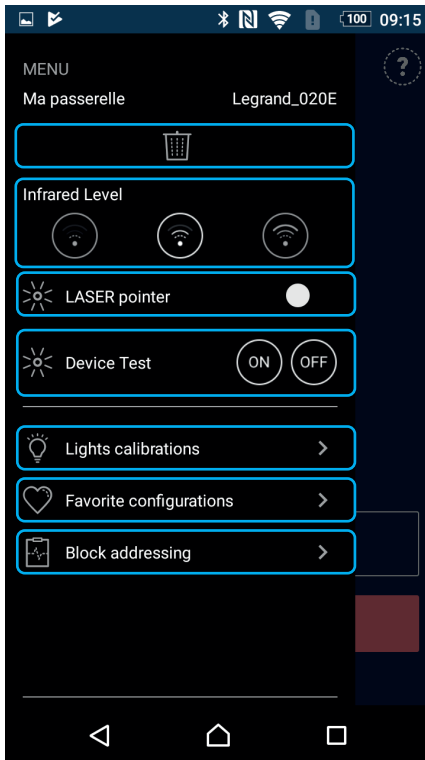

5.0.1 Select a tool (gateway)

Used to delete the default connected tool.



In order to pair another tool (gateway), you need to quit the app and restart it.

A selection list will then appear.

The newly selected tool will then be the default tool (gateway).

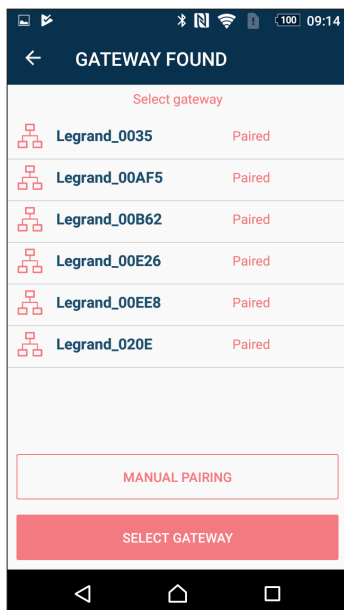

4. NAVIGATION (continued)

4.1 Main menu (continued)

5.0.2 Infrared level

Used to change the infrared cell power level:

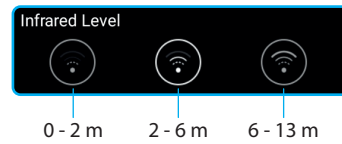

5.0.3 Laser pointer

Used to activate or deactivate the laser pointer. Once activated, it is only triggered when scanning a product.

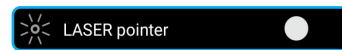

5.0.4 Test

Used to test whether Legrand Group lighting and detection products which can be controlled by the tool are ON or OFF.

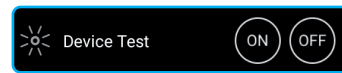

5.0.5 Lights calibration

Used to select one or more settings in order to copy them faster.

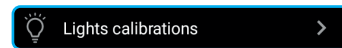

5.0.6 Favorite configurations

Used to create standard configurations.

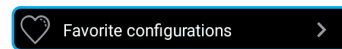

5.0.7 Block addressing

Used to address emergency lighting units according to a .csv file issued by the LVS2 supervision software or one unit at a time.

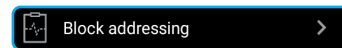

4. NAVIGATION (continued)

4.2 Manage settings files

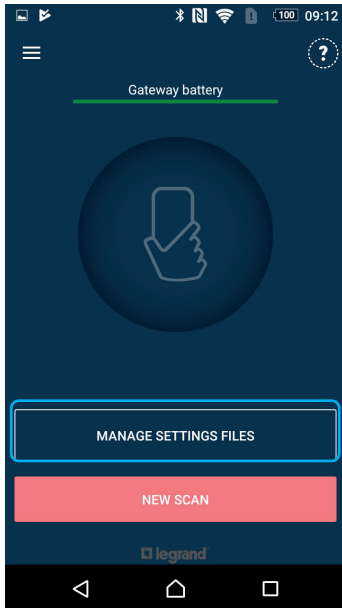

Used to manage saved or preset settings files.

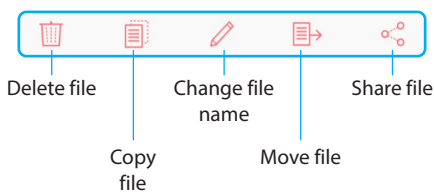
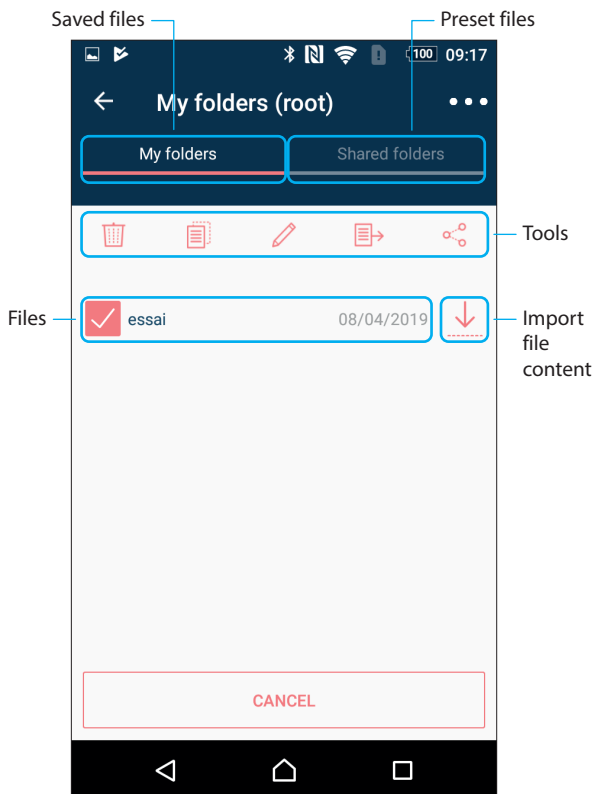

4. NAVIGATION (continued)

4.2 Manage settings files (continued)

5.0.8 Options

⋮ — Used to organise files

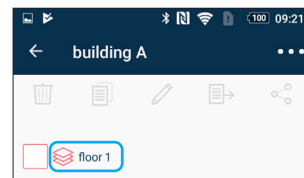
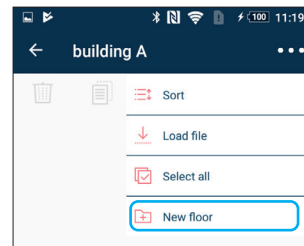
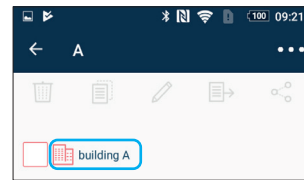
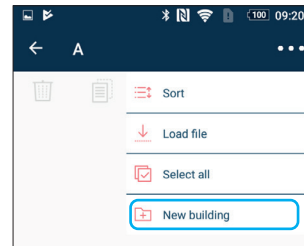
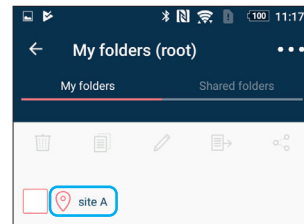
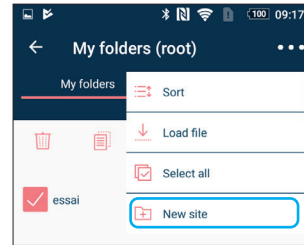

4. NAVIGATION (continued)

4.3 Scan product settings

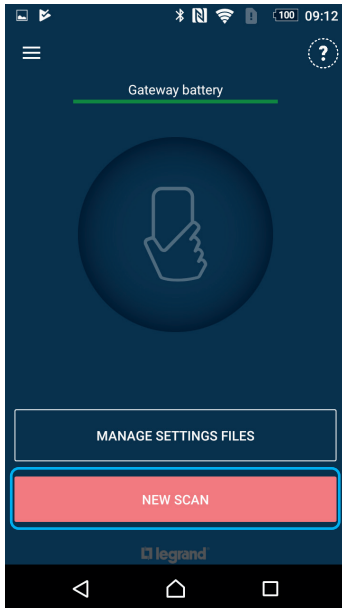

Used to scan a product and set its parameters.

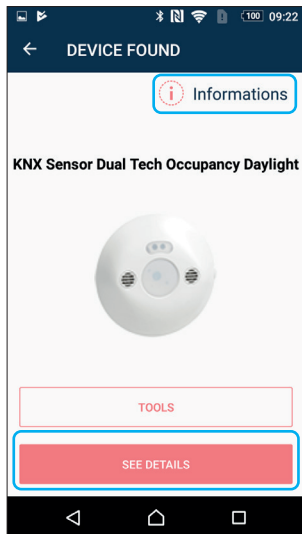

Link back to the website [www.legrandoc.com](http://www.legrandoc.com)

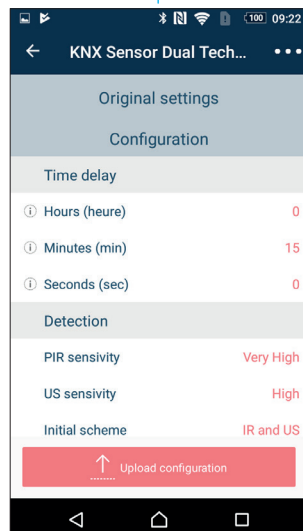

4. NAVIGATION (continued)

4.3 Scan product settings (continued)  
5.0.9 Settings details/copy

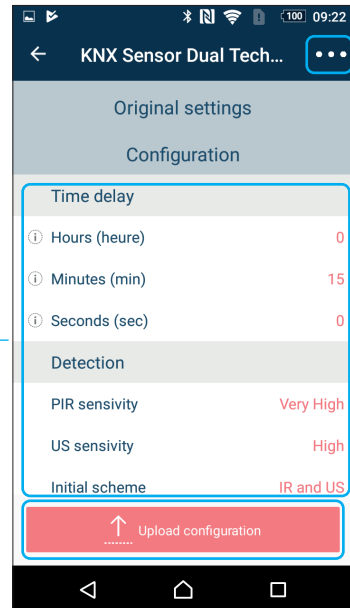

Options

Modifiable parameters

Options:

- Restores the original settings — Reset
- Link back to the website [www.legrandoc.com](http://www.legrandoc.com) — Informations
- Compares settings with other products — Compare
- Shares configuration data — Share configuration
- Saves the configuration — Save configuration
- Saves the selected settings — Save macro
- Loads other product settings — Load parameter

**4. NAVIGATION (continued)**

■ **4.3 Scan product settings (continued)**  
**5.0.10 Transfer product settings**

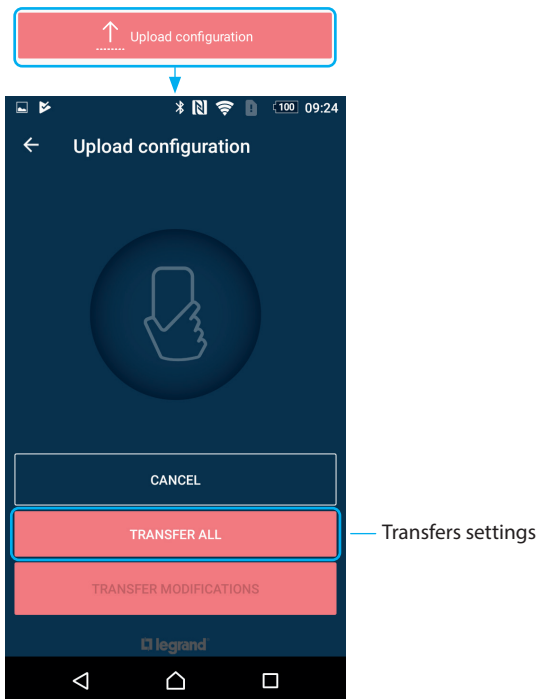

**5. CARE**

Do not use acetone, tar-removing cleaning agents or trichloroethylene.  
 Resistant to the following products: - Hexane (EN 60669-1)  
 - Methylated spirit  
 - Soapy water  
 - Diluted ammonia  
 - Bleach diluted to 10%  
 - Window-cleaning products

**Caution:**

Always test before using other special cleaning products.

**6. STANDARDS**

Directive: EC

Product standards:

- + IEC 60825-1 (Safety of laser products)
- + EN/IEC 62368-1 (Audio/video, information and communication technology equipment)
- + EN 300330 (Radio equipment)
- + EN 300328 (Electromagnetic compatibility and radio spectrum matters)

Environmental standards:

- European directive 2002/96/EC: WEEE (Waste Electrical and Electronic Equipment)
- European directive 2002/95/EC: RoHS (Restriction of Hazardous Substances)