

Equinox 40 LCD KEYPAD

User Interfaces



With a minimalistic on-wall presence, the Equinox 40 LCD keypad maintains a signature Vantage aesthetic while delivering complete room control through a unique single layer programmable interface. This revolutionary LCD keypad simplifies control of lighting, audio and home climate scenarios in a single-gang form factor that is compatible with global installation and electrical standards.

The Titanium frame and glass to edge surface aesthetic blends to any decor and provides a harmonious on-wall design consistent with other Vantage keypads, wiring, and connectivity devices. The keypad station is connected to the Vantage system via Vantage station bus. Sized and positioned as a standard light switch, Equinox 40 delivers the equivalent control of up to 9 keypad station buttons plus audio and climate control. The backlit 4.3" LCD panel has an auto presence detection and auto dim to OFF power saver mode with immediate ON and quick to control access when presence is detected.

Utilizing the power of Vantage's Design Center software Equinox devices come with both a predefined graphical environment and an auto-configuration capability that allow Integrators to efficiently create intuitive screens that are consistent with the entire Vantage graphical user environment. Audio and climate mini-widgets provide a UI environment that eliminates the need for additional wall mounted hardware for audio and climate control. In addition to the "home" page two additional pages are revealed by flicking left/right. Pages can be set as additional time of day lighting scenes, personalized to different users, or set by activity (shades, lighting, pool/spa etc.) via Design Center.

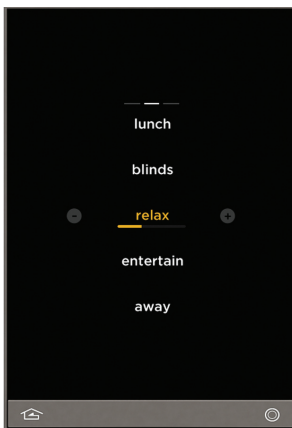
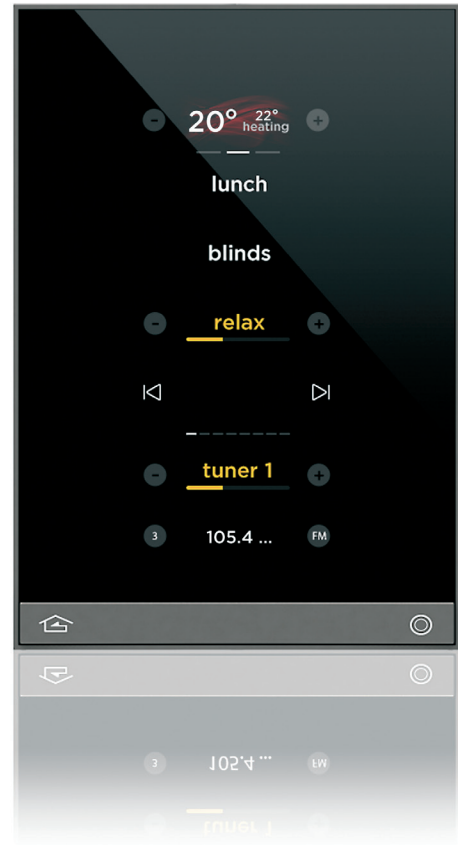

Product Highlights

- 4.3" LCD panel
- Titanium TrimLine II frame, glass to edge surface aesthetic
- Ambient light sensor for auto Day/Night backlighting
- Active IR sensors for approach On & Auto sleep modes
- Powered by InFusion
- Prescribed GUI personalized through Design Center
- Uses standard US and European wall box mechanics
- Dynamically updated
- Low power consumption
- Tap, swipe, press and hold

EQUINOX 40 LCD KEYPAD

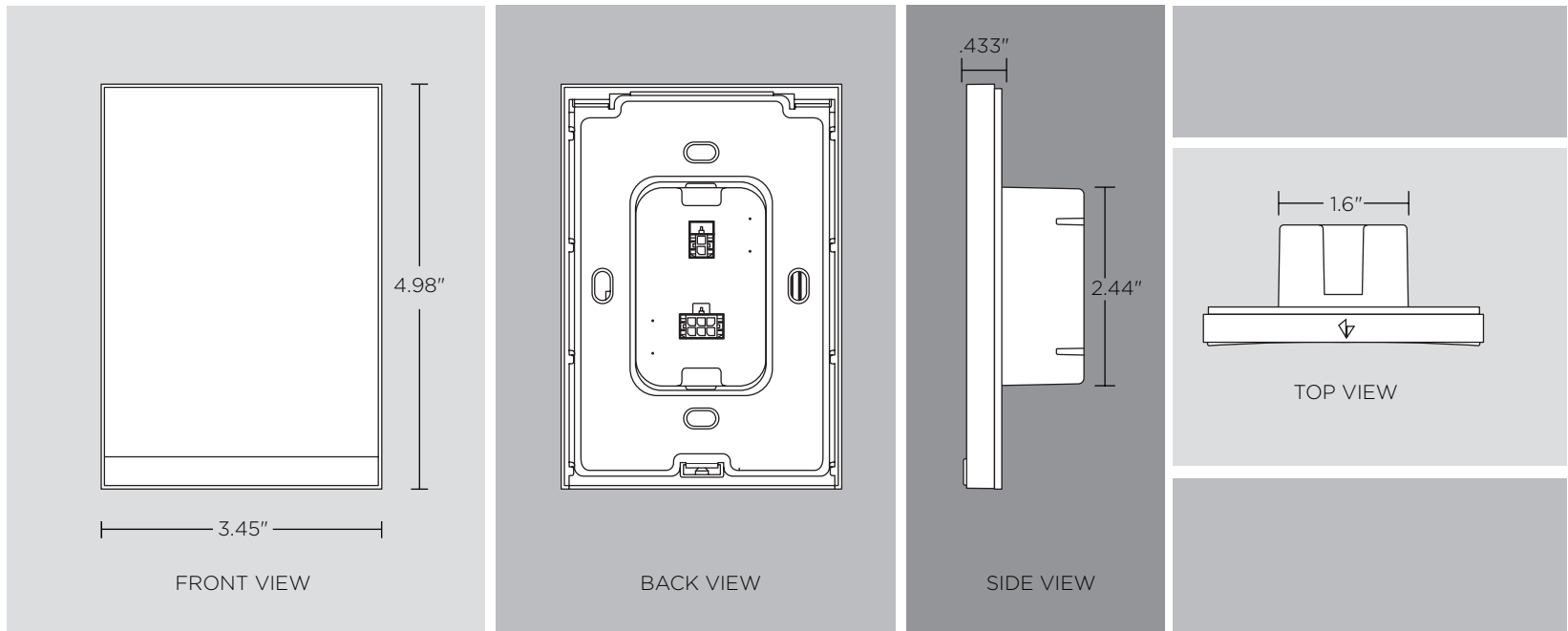

Specifications

Dimensions, HWD

4.98" x 3.45" x 1.49" (0.45" off wall)
126mm x 88mm x 38mm (11mm off wall)

General Specifications

Models	EQ40TB-TI
Hard Buttons	1 Home, 1 Programmable
Display	Active Matrix Color LCD
Size	4.3" Diagonal
Colors	16 Bit Color
Connectors	1-Station Bus, 1-Auxillary Pigtail
Operating Temperature	50°F - 104°F (10°C - 40°C)
Operating Humidity	10 - 90% non-condensing
Certification	CE, FCC

Mini Widget Integration

Equinox 40 has three mini widget areas: The top, middle and bottom of the LCD keypad

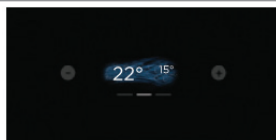

Comfort

Top Widget Area - Comfort/Climate/Clock/Blank/Weather

Provides relevant thermostat, weather or clock information

Thermostats Supported - Vantage, Aprilaire, as well as internal and external temperature sensors

Weather Supported - Current outside temperature



Climate

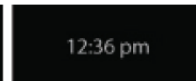

Clock



Blank



Weather

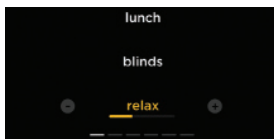

Middle Widget Area - Scenes

Provides standard button control and feedback for any scene

Supported Button Count - Max three per page with audio, max five per page without audio

Supported Page Count - Max three

Supported Scenes - All Vantage tasks for lighting, draperies/shades, A/V, pool/spa, drivers, conditional logic, etc.

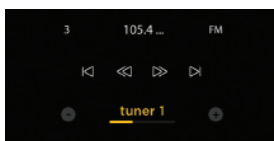

Bottom Widget Area - Audio

Provides single zone audio control for power, volume, source selection, playlists, tuner presets and transport commands

Supported Multi-room Systems - Vantage 450, 850, Nuvo Grand Concerto

Sources Supported - Vantage DMM, Vantage IMS, Autonomic Mirage MMS, Mozaex Solo, Nuvo Music Port, Nuvo T2, Nuvo iPod Dock, Russound ST2, Speakercraft STT2, Elan DTNR, Onkyo T4555, Integra TUN 3.7, iPort FS/IW

System Compatibility

InFusion

Vantage emea nv/sa
Binnendijk 40 | 9130 Beveren | Belgium
T +32 (0) 3 773 31 06 | F +32 (0) 3 773 31 05
www.vantage-emea.com